

DATE	ISS	DESCRIPTION OF CHANGE	DR
31/03/14	1	INITIAL ISSUE	

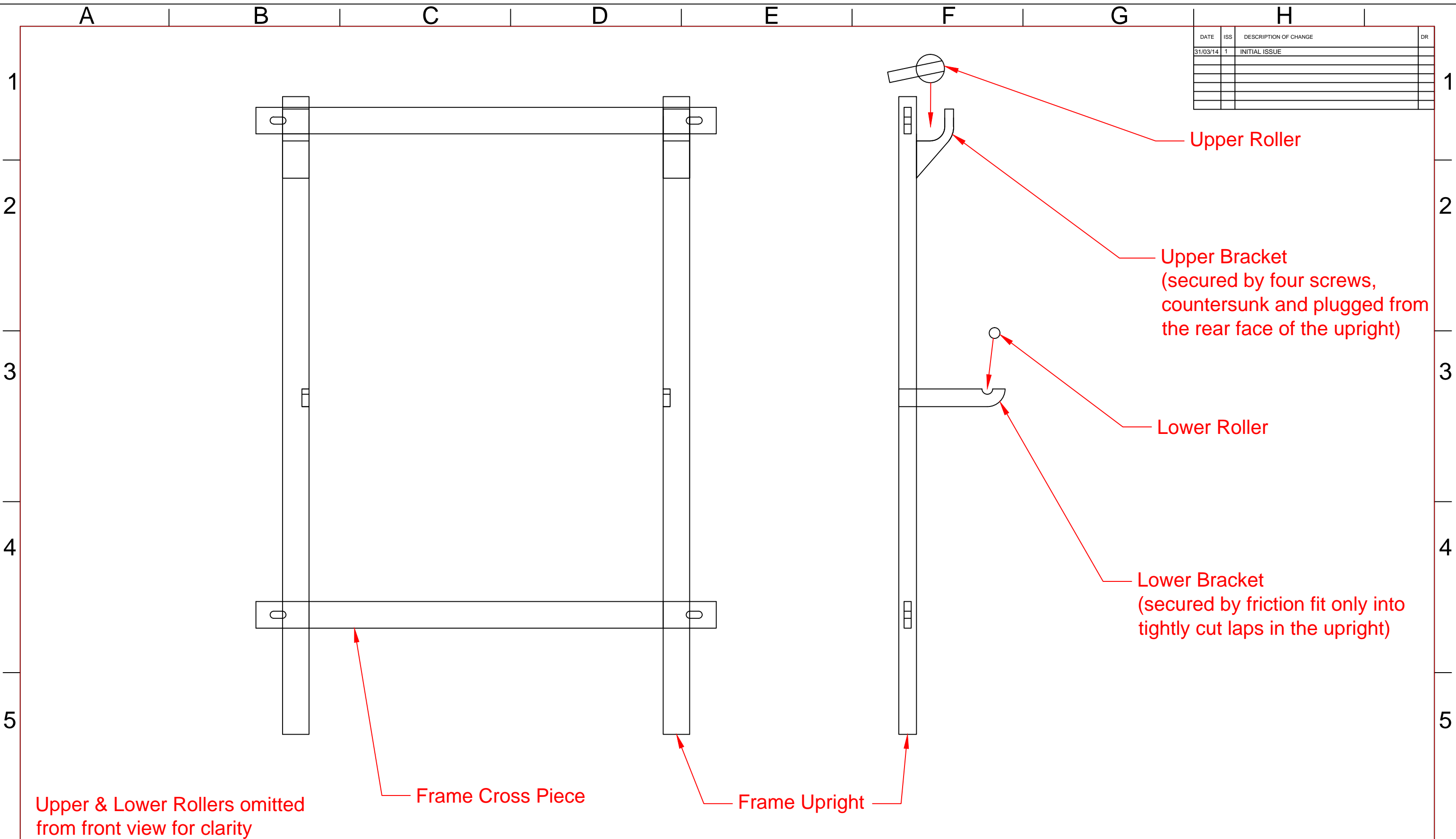

Upper & Lower Rollers omitted from front view for clarity

Frame Cross Piece

Frame Upright

Upper Roller

Upper Bracket  
(secured by four screws,  
countersunk and plugged from  
the rear face of the upright)

Lower Roller

Lower Bracket  
(secured by friction fit only into  
tightly cut laps in the upright)

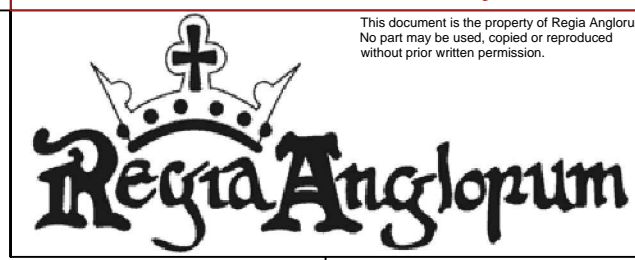

This document is the property of Regia Anglorum  
No part may be used, copied or reproduced  
without prior written permission.

UNLESS OTHERWISE SPECIFIED  
REFER TO BS8888  
ALL DIMENSIONS ARE IN MM  
DIMENSIONAL TOLERANCES:  
X = +/-1.0  
X.X = +/-0.5  
X.XX = +/-0.2  
ANGULAR TOLERANCE = +/-1.0deg.  
REMOVE ALL BURRS AND SHARP  
EDGES

IF IN DOUBT ASK  
DO NOT SCALE PRINT  
PROJECTION

DRAWN BY  
TG  
APPROVED BY  
SHT SIZE  
A2

DRAWN DATE  
31/03/14  
DATE OF APPROVAL  
SCALE  
1:1

MATERIAL  
Joinery Grade Oak  
FINISH

TITLE  
Assembly Layout  
DESCRIPTION  
Warp Weighted Loom  
WEIGHT

DRAWING NO.

SHEET 1 of 1	REV 1
-----------------	----------

A B C D E F G H

DATE	ISS	DESCRIPTION OF CHANGE	DR
31/03/14	1	INITIAL ISSUE	

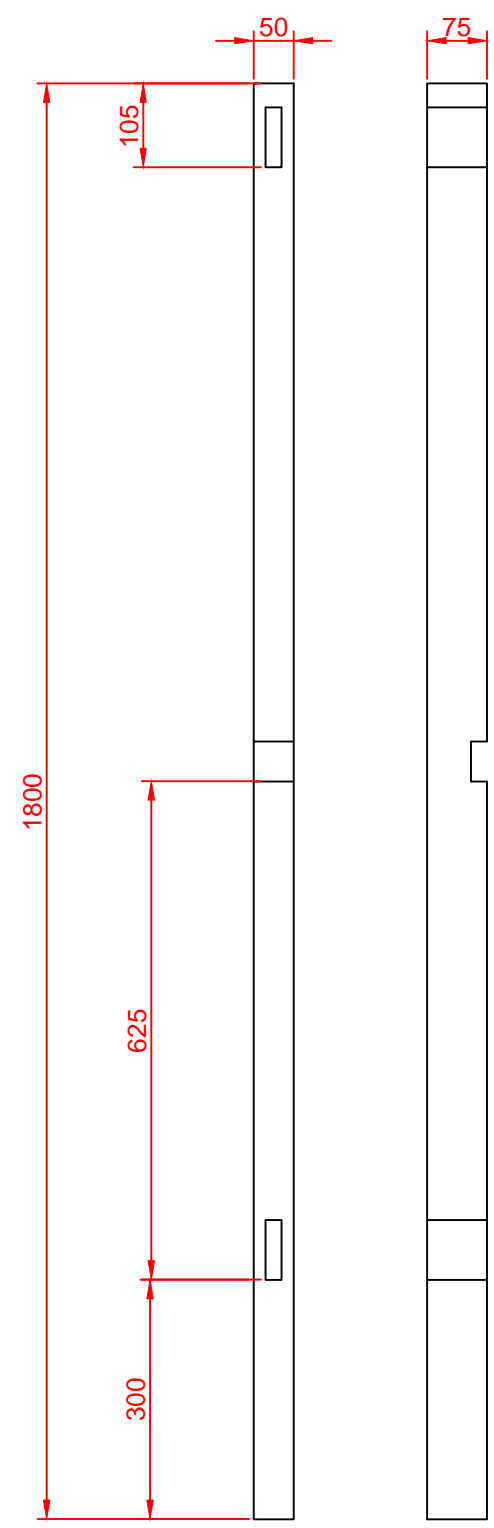

Number required: 2

Cut to length if required

Thickness to 75mm x 50mm

Cut through mortices with chisel

Cut lap with tenon saw & chisel

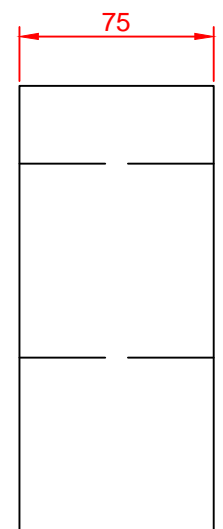
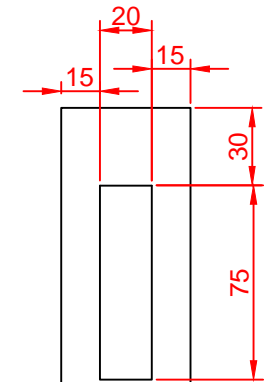

Mortice (Detail)

Lap (Detail)

Cut on opposite sides on each upright such that they are handed

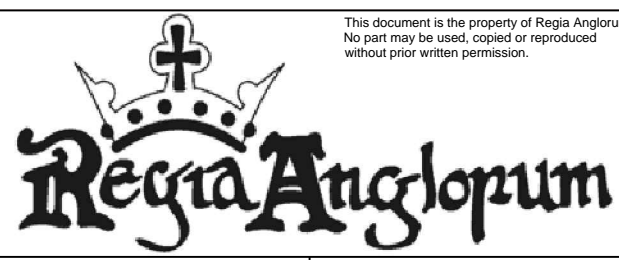
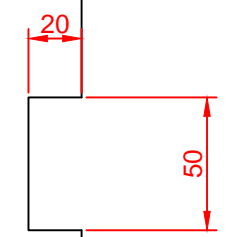

This document is the property of Regia Anglorum  
No part may be used, copied or reproduced  
without prior written permission.

UNLESS OTHERWISE SPECIFIED  
REFER TO BS8888  
ALL DIMENSIONS ARE IN MM  
DIMENSIONAL TOLERANCES:  
X = +/-1.0  
X.X = +/-0.5  
X.XX = +/-0.2  
ANGULAR TOLERANCE = +/-1.0deg.  
REMOVE ALL BURRS AND SHARP  
EDGES

IF IN DOUBT ASK

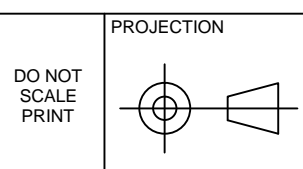

DO NOT  
SCALE  
PRINT

DRAWN BY  
TG

DRAWN DATE  
31/03/14

MATERIAL  
Joinery Grade Oak

TITLE  
Frame Upright General Layout

DESCRIPTION  
Warp Weighted Loom

APPROVED BY

DATE OF APPROVAL

FINISH

SHT SIZE  
A2

SCALE  
1:1

WEIGHT

DRAWING NO.

SHEET  
1 of 1

REV  
1

DATE	ISS	DESCRIPTION OF CHANGE	DR
31/03/14	1	INITIAL ISSUE	

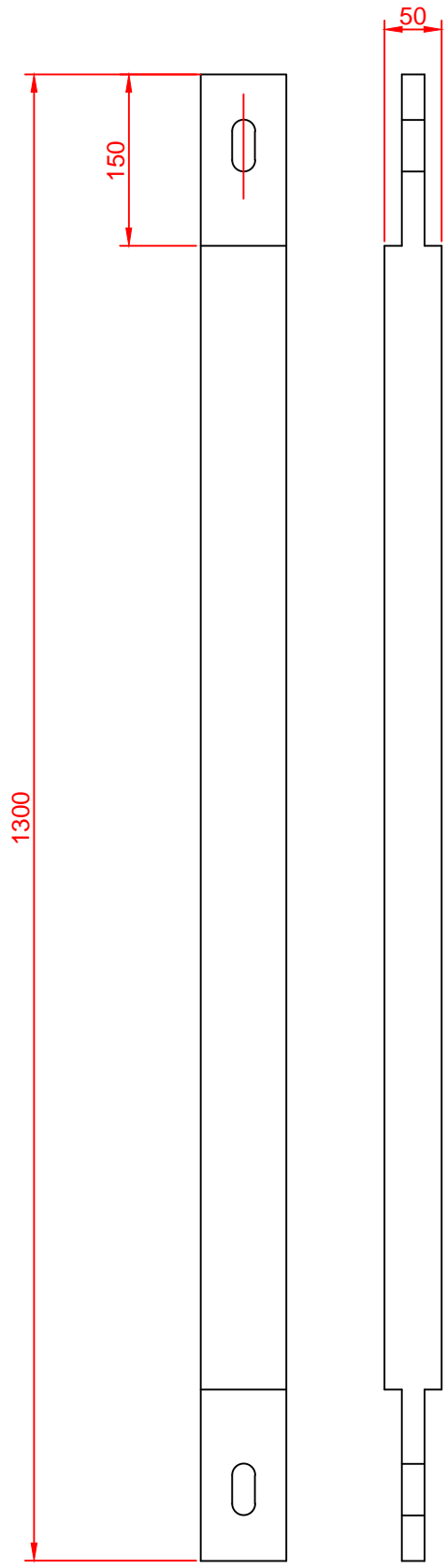

Number required: 2  
 Cut to length if required  
 Thickness to 75mm x 50mm  
 Cut tenons with tenon saw and bandsaw  
 Cut peg sockets with drill and chisel

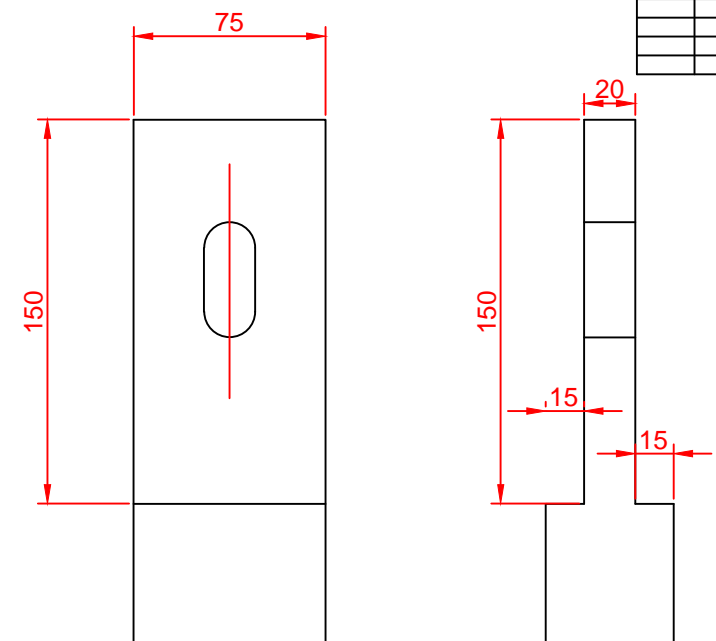

Tenon (Detail)

Peg Sockets (Detail)

Drill two wholes and connect with chisel, remembering to use a piece of scrap on the back when drilling.

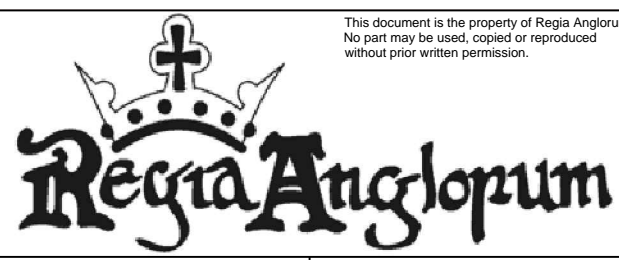
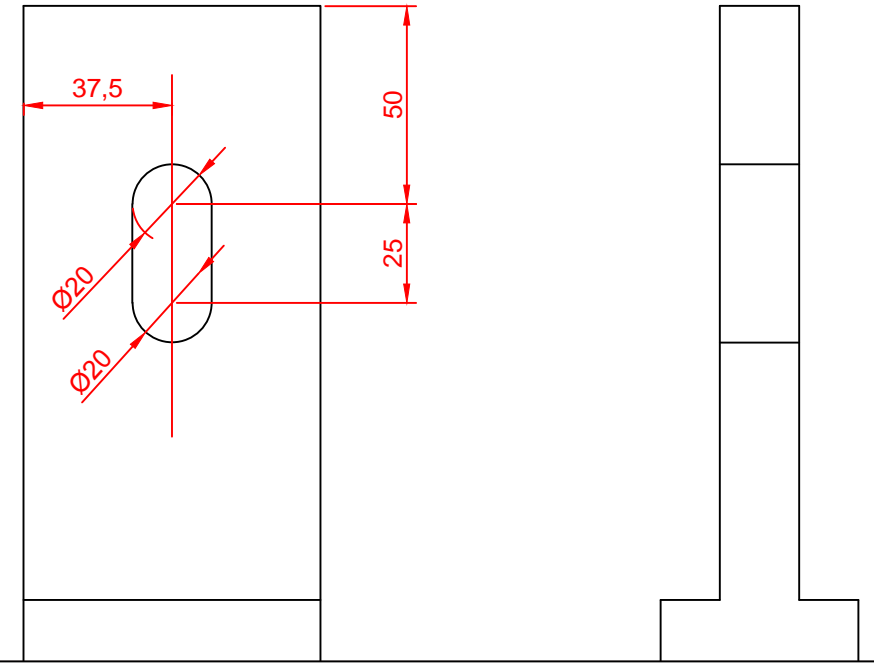

This document is the property of Regia Anglorum  
 No part may be used, copied or reproduced  
 without prior written permission.

UNLESS OTHERWISE SPECIFIED  
 REFER TO BS8888  
 ALL DIMENSIONS ARE IN MM  
 DIMENSIONAL TOLERANCES:  
 X = +/-1.0  
 X.X = +/-0.5  
 X.XX = +/-0.2  
 ANGULAR TOLERANCE = +/-1.0deg.  
 REMOVE ALL BURRS AND SHARP EDGES

IF IN DOUBT ASK

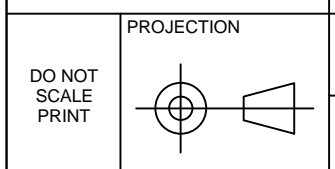

DRAWN BY: TG  
 DRAWN DATE: 31/03/14  
 APPROVED BY:  
 DATE OF APPROVAL:  
 SHT SIZE: A2  
 SCALE: 1:1

MATERIAL: Joinery Grade Oak  
 FINISH:

TITLE: Frame Cross Piece General Layout  
 DESCRIPTION: Warp Weighted Loom  
 WEIGHT:  
 DRAWING NO.:  
 SHEET: 1 of 1  
 REV: 1

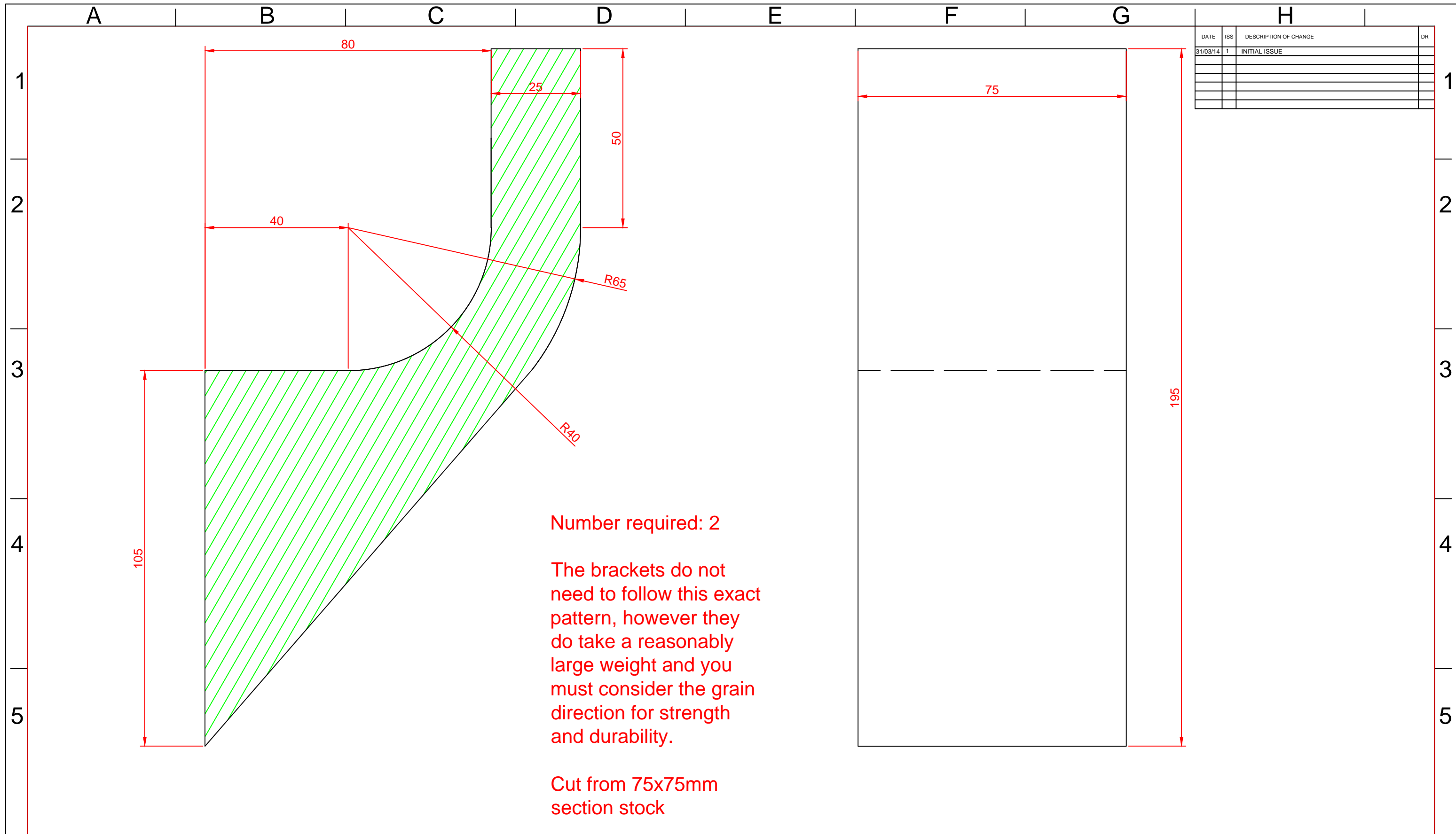

DATE	ISS	DESCRIPTION OF CHANGE	DR
31/03/14	1	INITIAL ISSUE	

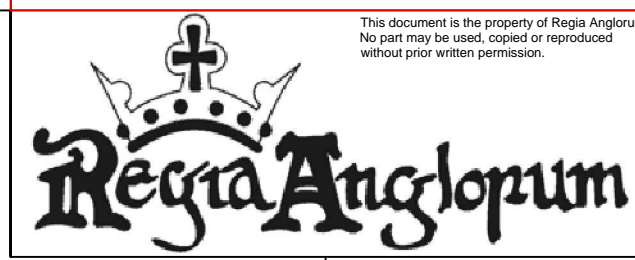

This document is the property of Regia Anglorum  
No part may be used, copied or reproduced  
without prior written permission.

UNLESS OTHERWISE SPECIFIED  
REFER TO BS8888  
ALL DIMENSIONS ARE IN MM  
DIMENSIONAL TOLERANCES:  
X = +/-1.0  
X.X = +/-0.5  
X.XX = +/-0.2  
ANGULAR TOLERANCE = +/-1.0deg.  
REMOVE ALL BURRS AND SHARP  
EDGES

IF IN DOUBT ASK

DO NOT  
SCALE  
PRINT

DRAWN BY  
TG

DRAWN DATE  
31/03/14

APPROVED BY

DATE OF APPROVAL

SHT SIZE  
A2

SCALE  
1:1

MATERIAL  
Joinery Grade Oak

FINISH

TITLE  
Upper Bracket Layout

DESCRIPTION  
Warp Weighted Loom

WEIGHT

DRAWING NO.

SHEET  
1 of 1

REV  
1

DATE	ISS	DESCRIPTION OF CHANGE	DR
31/03/14	1	INITIAL ISSUE	

Number required: 2

The brackets do not need to follow this exact pattern. If adjusting the width and thickness, be sure to correct the dimensions of the lap in the Frame Uprights to match.

The grain direction shown is preferable to increase strength in the tip, however it does increase wastage and is optional.

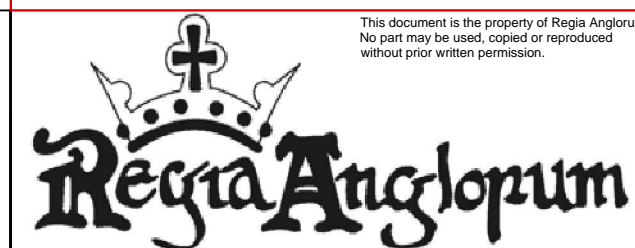
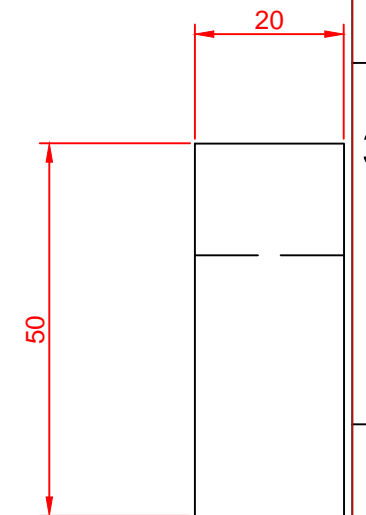
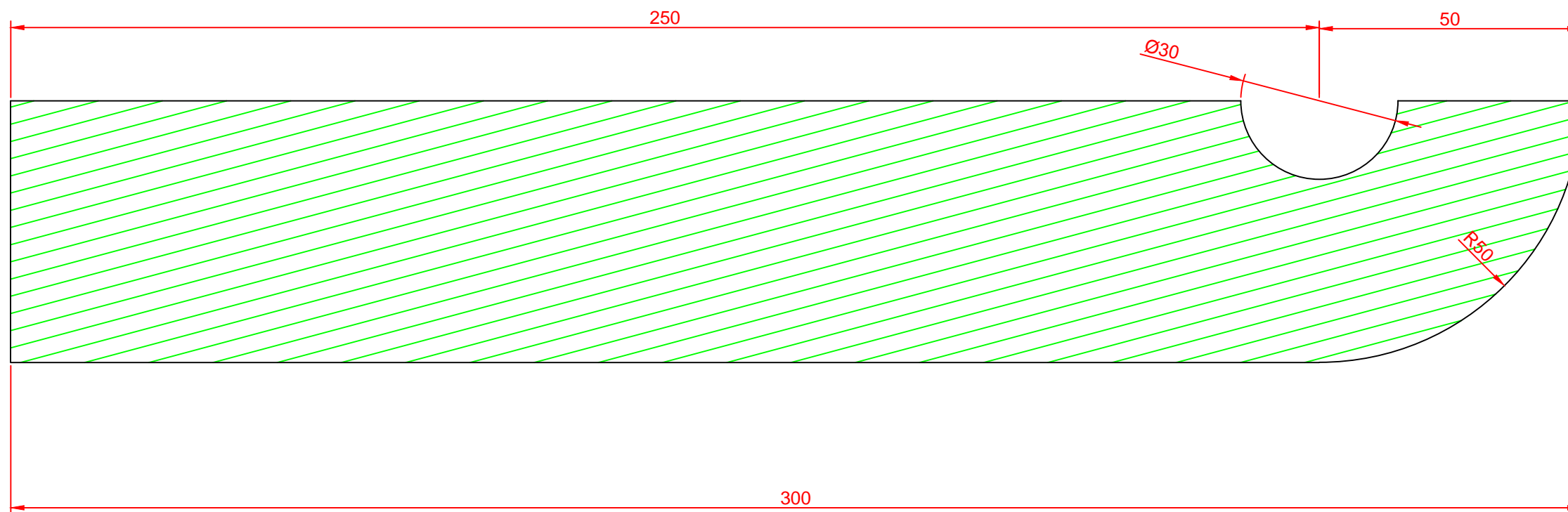

This document is the property of Regia Anglorum  
No part may be used, copied or reproduced  
without prior written permission.

UNLESS OTHERWISE SPECIFIED  
REFER TO BS8888  
ALL DIMENSIONS ARE IN MM  
DIMENSIONAL TOLERANCES:  
X = +/-1.0  
X.X = +/-0.5  
X.XX = +/-0.2  
ANGULAR TOLERANCE = +/-1.0deg.  
REMOVE ALL BURRS AND SHARP  
EDGES

IF IN DOUBT ASK

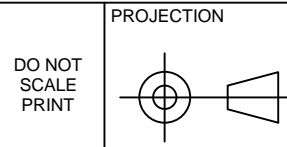

DRAWN BY TG	DRAWN DATE 31/03/14
APPROVED BY	DATE OF APPROVAL
SHT SIZE A2	SCALE 1:1

MATERIAL Joinery Grade Oak
FINISH

TITLE Upper Bracket Layout
DESCRIPTION Warp Weighted Loom

WEIGHT	DRAWING NO.	SHEET 1 of 1	REV 1
--------	-------------	-----------------	----------

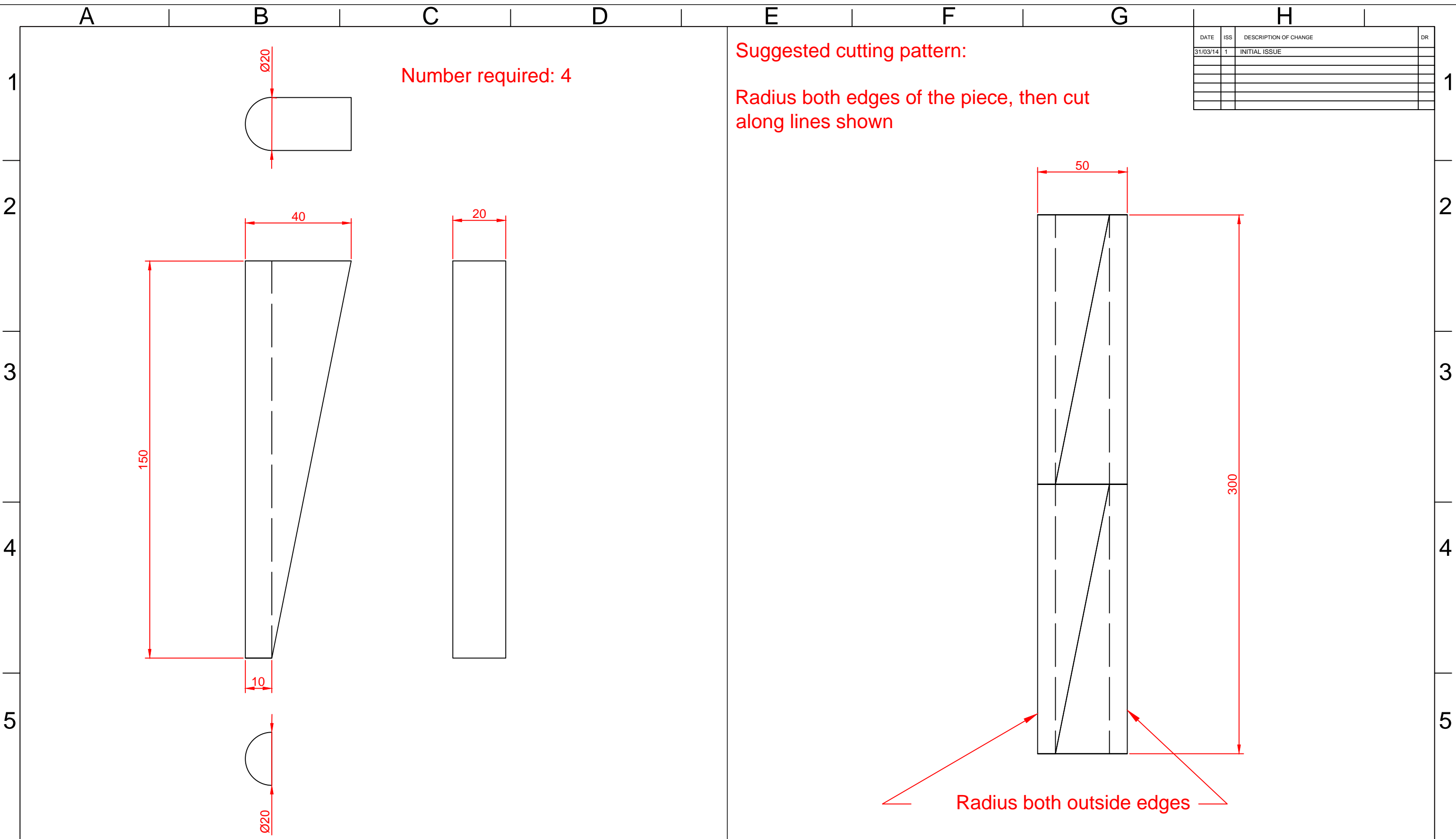

DATE	ISS	DESCRIPTION OF CHANGE	DR
31/03/14	1	INITIAL ISSUE	

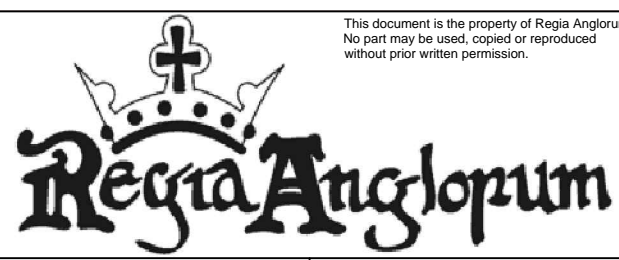

This document is the property of Regia Anglorum  
No part may be used, copied or reproduced  
without prior written permission.

UNLESS OTHERWISE SPECIFIED  
REFER TO BS8888  
ALL DIMENSIONS ARE IN MM  
DIMENSIONAL TOLERANCES:  
X = +/-1.0  
X.X = +/-0.5  
X.XX = +/-0.2  
ANGULAR TOLERANCE = +/-1.0deg.  
REMOVE ALL BURRS AND SHARP  
EDGES

IF IN DOUBT ASK

DO NOT SCALE PRINT

PROJECTION

DRAWN BY  
TG

DRAWN DATE  
31/03/14

APPROVED BY

DATE OF APPROVAL

SHT SIZE  
A2

SCALE  
1:1

MATERIAL  
Joinery Grade Oak

FINISH

TITLE  
Frame Peg General Layout

DESCRIPTION  
Warp Weighted Loom

WEIGHT

DRAWING NO.

SHEET  
1 of 1

REV  
1

**Upper Roller**

Number required: 1

If planing from square stock, suggest drilling peg holes first

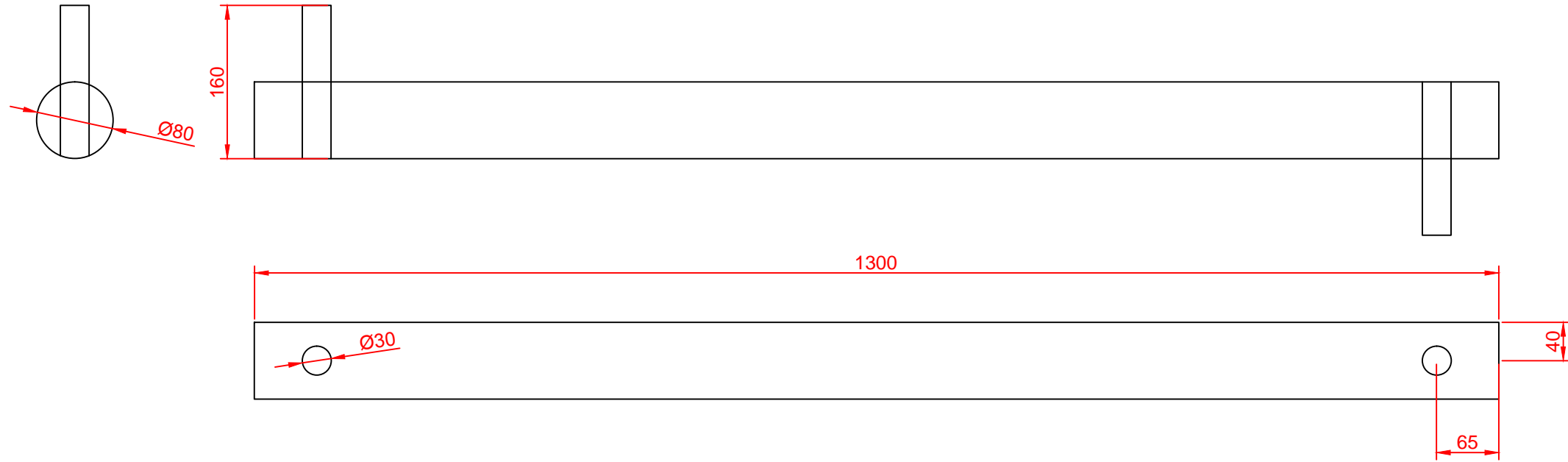

DATE	ISS	DESCRIPTION OF CHANGE	DR
31/03/14	1	INITIAL ISSUE	

**Lower Roller**

Number required: 1

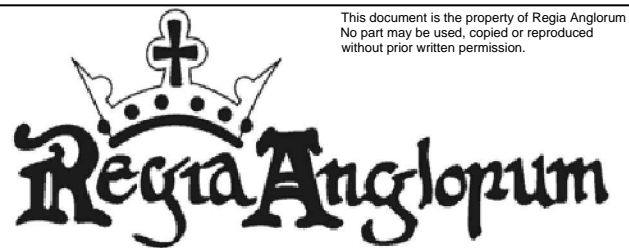
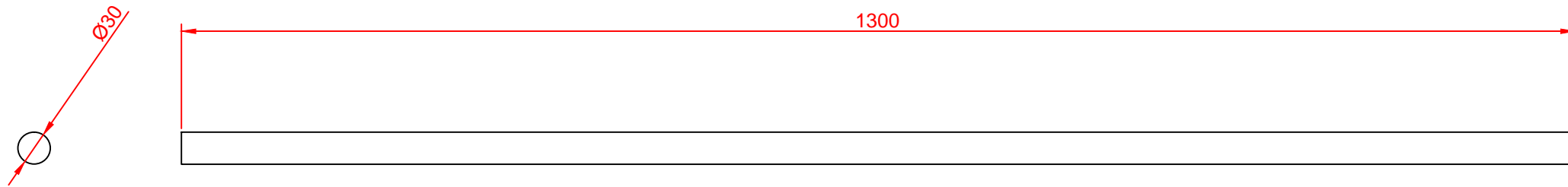

This document is the property of Regia Anglorum  
No part may be used, copied or reproduced  
without prior written permission.

UNLESS OTHERWISE SPECIFIED

REFER TO BS8888  
ALL DIMENSIONS ARE IN MM  
DIMENSIONAL TOLERANCES:  
X = +/-1.0  
X.X = +/-0.5  
X.XX = +/-0.2  
ANGULAR TOLERANCE = +/-1.0deg.  
REMOVE ALL BURRS AND SHARP  
EDGES

IF IN DOUBT ASK

DO NOT  
SCALE  
PRINT

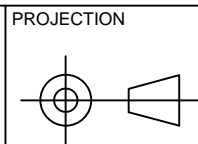

DRAWN BY  
TG

DRAWN DATE  
31/03/14

MATERIAL  
European Ash

TITLE  
Roller General Layout

DESCRIPTION  
Warp Weighted Loom

APPROVED BY

DATE OF APPROVAL

FINISH

SHT SIZE  
A2

SCALE  
1:1

WEIGHT

DRAWING NO.

SHEET  
1 of 1

REV  
1